

# FLORIDA



MARCO ESTÁNDAR DE SERIE  
STANDARD FRAME  
MOLDURA STANDART DE SÉRIE  
CORNICE DI SERIE STANDARD  
CADRE STANDARD DE SÉRIE



SDC



SCL



SSV



SBE



14



80,54



4,2



350



508x282x320



82



200



2x120



2x160



58

## Features

- Double Combustion System
- Clean Glass System
- Security System in Fans
- Low Emissions System
- Heating power: 14kw
- Efficiency (%): 80,54%
- Consumption (kg/h): 4,2kg/h
- Heating capacity (m3): 350m3
- Vermiculite inside
- Manufactured in cast-iron and steel
- Weight (kg): 82kg
- Smoke exit tube diameter (mm): 200mm
- Air channel (diameter and exit tube number): 2x120
- Forced ventilation: 2x160
- Useful chamber measures: 508x282x320mm
- Maximum logs size (cm): 58cm

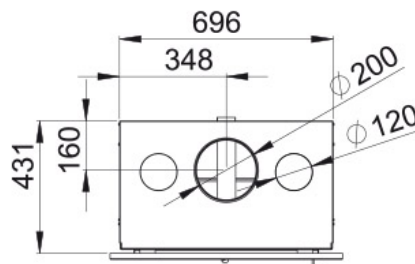
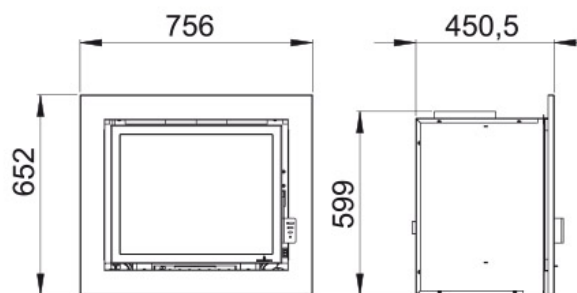

Given the continued improvement of our products and improving our manufacturing process, size, aesthetics and product specifications are subject to change without prior notice from our company.

[www.bronpi.com](http://www.bronpi.com)

