

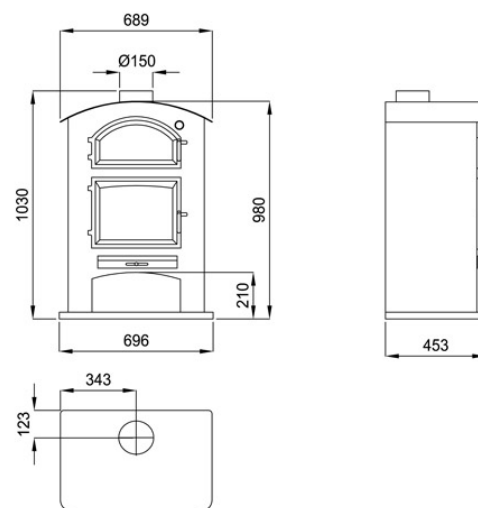

Features

- Clean Glass System
- Heating power: 9kW
- Efficiency (%): 77%
- Consumption (kg/h): 2,5kg/h
- Heating capacity (m³): 225m³
- Metallic inside
- Manufactured in cast-iron and sheet
- Weight (kg): 112kg
- Smoke exit tube diameter (mm): 150mm
- Clean glass system
- Useful chamber measures: 370x285x370mm
- Useful chamber measures: 370x200x230mm
- Maximum logs size (cm): 55cm



Medida Boca Util: 370 x 285 x 370 mm
Medida Horno Util: 370 x 200 x 230 mm

Given the continued improvement of our products and improving our manufacturing process, size, aesthetics and product specifications are subject to change without prior notice from our company.

www.bronpi.com