



11



81



2,9



275



72



150



400x295x328



47

Features

- Double Combustion System
- Clean Glass System
- Heating power: 11kw
- Efficiency (%): 81%
- Consumption (kg/h): 2,9kg/h
- Heating capacity (m3): 275m3
- Vermiculite inside
- Manufactured in cast-iron and steel
- Weight (kg): 72kg
- Smoke exit tube diameter (mm): 150mm
- Useful chamber measures: 400x295x328mm
- Maximum logs size (cm): 47cm

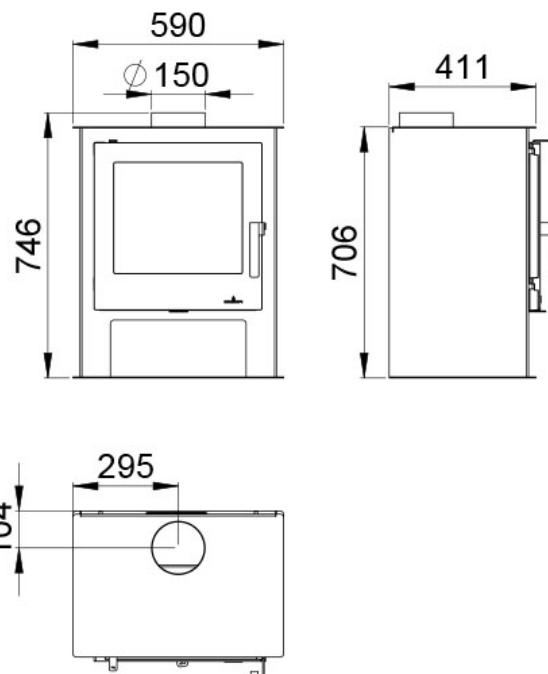

Given the continued improvement of our products and improving our manufacturing process, size, aesthetics and product specifications are subject to change without prior notice from our company.

www.bronpi.com

